

EPAK-CI-4CO

Isolator Manual

Model Type: EPAK-CI-4CO

Order Number: 7760054308



Caution

- Please check the product type model and the specification on the product outside wrapping in order to ensure they are according with the purchase contract.
- Carefully read and understand this manual before using this product. Any question, please contact our company technical support hotline for assistance.
- Isolator should be installed in proper area.
- Power supply is 24VDC, 220VAC is strictly forbidden.
- Customer is not allowed to repair the products.

■ Introduction

Isolator can connect with current source signal. The signal 0/4~20mA is isolated and transferred through output side. The product should be supplied by 20~30VDC power independently and it is 3-way isolation between power supply, input and output port.

■ Specification

Channel:	4
Input:	
Input signal:	Current source
Current range:	0~20mA or 4~20mA
Input impedance:	≤100Ω
Maximum current:	30mA
Output:	
Current range:	0~20mA or 4~20mA
Output load:	≤300Ω
Accuracy:	0.1%F.S.
Temperature coefficient:	300ppm/K
Response time:	≤500ms
Power supply:	
Supply voltage:	20~35V DC
Current consumption:	≤80mA(24V power supply,20mA output)
Power protection:	Inverse protection
Insulation coordination:	
Standards:	EN61010-1
EMC standards:	IEC61326-1
Rated voltage:	300V
Impulse withstand voltage:	3000V(1.2/50μs)
Isolation voltage:	1500V
Overvoltage category:	II
Pollution severity:	2

■ General

The surrounding air should not include the material which can corrupt the coating of chrome,nickel. And the installation cabinet should not subsist electromagnetism induction influence,such as violent quiver or impact,big current spark and so on.

Operating temperature: -20℃ to+60℃
Storage temperature: -40℃ to+85℃
Relative humidity: 5% to 95%RH
Housing: EPAK
Weight: approx.100g

■ Wiring

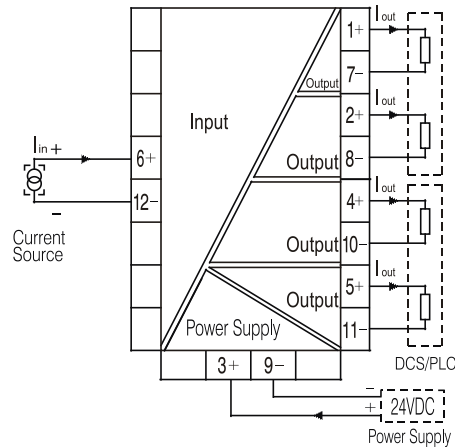

■ Dimensions

HeightXLengthXWidth: 100X89X17.5(mm)

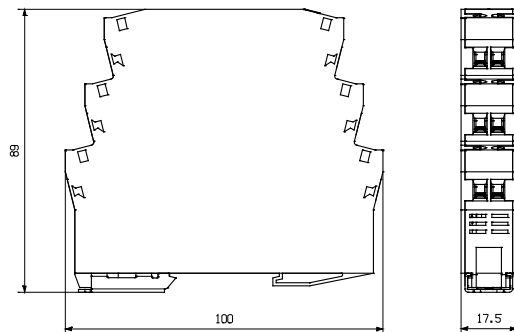

■ Front cover and terminal definition

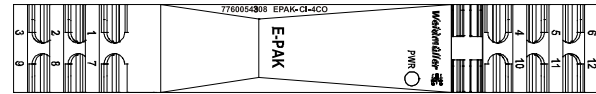

■ Installation

The product is designed to be mounted onto a TS 35 DIN rail. It clips onto the rail via a spring-loaded mounting foot and can be removed via a spring release on the edge of the product near the mounting rail.

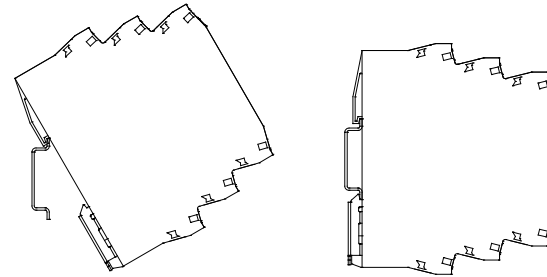

■ Uninstallation

Please refer to the following picture when try to uninstall the isolator from the Din rail. Insert the screw driver into the hold of the house feet and turn the screw driver to take off the isolator.

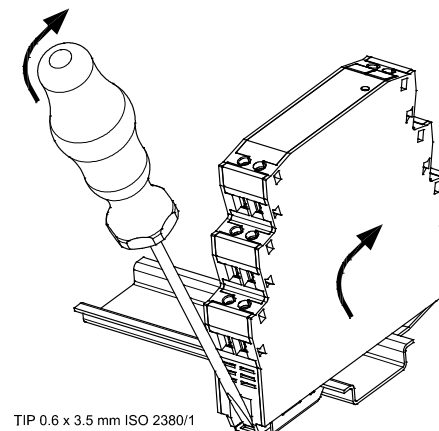

■ Marker

A device marker is located below the upper set of terminals for costumer identification.

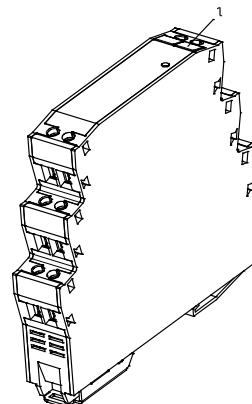

■ Maintenance

- (1)Before powering the isolator,make sure the models type is correct according to the design and the application environmental conditions.
- (2)Please choose the power supply with short circuit protection function.
- (3)After the electronic products have been powered for more than fifteen minutes, the temperaure of them should be stable.
- (4)It is strictly prohibited to test the insulation capability between any two terminals of the product by a mega-ohmmeter. All of the connecting wires of the isolator must be disconnected, before testing the insulation of the system, otherwise internal components will be destroyed.
- (5)Each product has been tested strictly and the quality is controlled rigidly. If you have any questions regarding this product, please contact the nearest distributor or our company technical support hotline directly for assistance.
- (6)In 12 months from delivery date, if the product works improperly in the process of normal usage, we will repair it without charge.

Weidmüller Interface GmbH Klingenbergstr.16
32758 Detmold
Germany

Weidmüller Interface (Shanghai) Co.,Ltd.
25F, BM Intercontinental Business Center, 100 Yutong Road, Shanghai,
China,200070
Phone:+86 21 2219-5008
Fax:+86 21 2219-5009
www.weidmueller.com