

Technical change for the ZDU 2.5/4AN feed through terminal block

Dear Madam or Sir,

the below listed articles will be supplied in a modified revision. Please pass this product information on to your employees and, if needed, to your customers. All modifications are performed for reasons of product improvements.

1. Initial situation

The current bars of the ZDU 2.5/4AN terminal block have lateral lugs on each connection which close the terminal connection space of the terminal block.

2. Technical change

The lugs of the terminals have been removed as part of the product optimization. The removal of these lugs has no effect on the technical properties of the terminal block.
In addition, the marking channel has been optimized. The marking channel now has a slip-off protection on both sides, which prevents markers from slipping out of the side of the terminal block.

Old Version

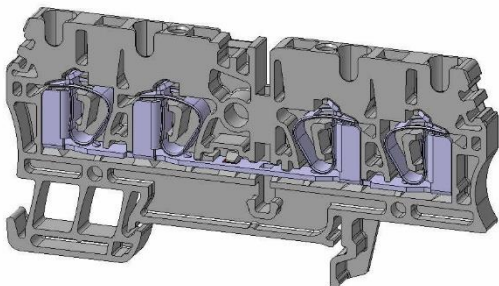

New Version

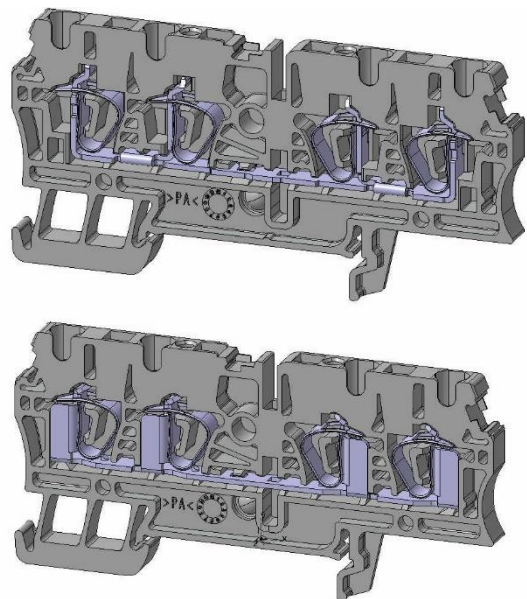

3. Reason for change

The change was made as part of a product optimization. This product optimization ensures the stabilization of product quality and contributes to the standardization of the portfolio.

4. Availability

The terminal blocks listed below will be delivered in the modified versions from July 2023 onwards. From this point on we will deliver both of the above-mentioned versions.

5. Affected parts

| <u>Article number</u> | <u>Article name</u> |
|-----------------------|---------------------|
| 1608570000 | ZDU 2.5/4AN |
| 1608580000 | ZDU 2.5/4AN BL |
| 1636800000 | ZDU 2.5/4AN OR |
| 1683420000 | ZDU 2.5/4AN RT |
| 1683430000 | ZDU 2.5/4AN GE |
| 1683440000 | ZDU 2.5/4AN GN |
| 1683470000 | ZDU 2.5/4AN GR |
| 1683480000 | ZDU 2.5/4AN WS |
| 1683490000 | ZDU 2.5/4AN SW |
| 1683460000 | ZDU 2.5/4AN BR |

We follow the advice of our customers and are constantly working on our products in order to improve them sustainably. We will implement these changes as smoothly as possible and without affecting delivery times and the functionality of the products.

For further questions please contact your sales office directly. All contacts for sales representatives are available here:
www.weidmueller.com/contact

Best regards

Product Management Modular Terminal Blocks
Business Unit Rail Mounted Components

Weidmüller Interface GmbH & Co. KG
Klingenbergstraße 26, 32758 Detmold, Germany

Weidmüller – Your partner in Industrial Connectivity
We look forward to sharing ideas with you – **Let's connect.**